

### System

Horiso Specialty Venetian Blinds - N Series

### Operation

#### Internal or External Installation

- Manual control by crank or pull cord (pull cord is for internal installation only and available in white).
- Motorised control via switch, remote control or tablet/hand-held device.
- Automation control at varying degrees of customisation.

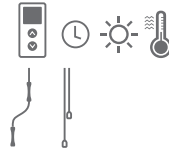

### Motor

Asynchronous box motors

- Quiet and reliable lift/tilt motor with soft break. 110 or 240 volts.
- UL certified motors.
- Compatibility with home automation systems and building management systems.
- Adjustable end limits.

### Timber Slats

#### Western red cedar

**Use:** Internal / External  
**Slat Widths:** 84mm wide x 4mm or 6mm (non-standard)  
**Colour Options:** Three variations of colour stains



#### Accoya®

**Use:** Internal / External  
**Slat Widths:** Various available  
**Colour Options:** Various available

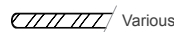

#### Paulownia

**Use:** Internal  
**Slat Widths:** 84mm wide x 5mm thickness  
**Colour Options:** Eight variations of colour finishes

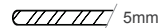

### Components

- Aluminium components:** 25 micron clear anodized.  
**Heavy duty cables:** Stainless steel cable with stainless steel mushroom head.  
**Lifting and tilting device:** High-strength, shrink-resistant and reinforced 100% Kevlar.  
**Termination Brackets:** L shaped face fix bracket.  
 Bottom termination (M8 Swage)  
 Top hat bottom termination bracket.

All steel components are stainless steel 316 marine grade.

### Installation

Internal or external installation.

- Installation into existing building recesses.
- Installation using top fix pelmet fitted onto building structure. Pelmet extensions are available.
- Installation using face fix pelmet fitted onto building structure. Pelmet extensions are available.
- Recommended use of a wind sensor for external installation for automatic retraction in high winds.

### System Limitations

Maximum coverage, width and drop per system:

- Dependent on timber selection. Please contact Horiso for more information.
- A centre cable is required for widths of over 3m on external installations and extreme high wind areas.

### Pelmets (Fascias)

#### Top fix

W: 145mm / H: 150mm

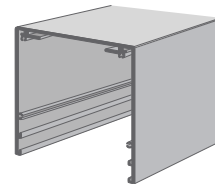

#### Top fix with end plate

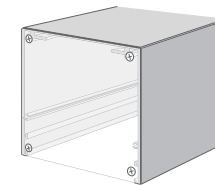

#### Face fix

W: 154mm / H: 150mm  
 Wall bracket: 18mm

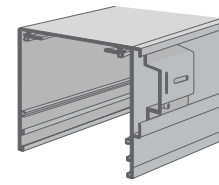

#### Pelmet extension

50mm increments

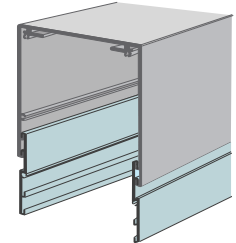

- Extruded aluminium 3 mm.
- Powder-coated in standard or custom colours, 25 micron clear anodised.
- Pelmet/fascia extensions in 50 mm increments.
- Custom pelmet/fascia solutions.

For stacking height information, please refer to the Specialty Venetian Blind brochure

© Copyright Feb 2021 Horiso. Information is subject to change without prior notice. Please refer to the Specialty Venetian Blind brochure for more detailed information.

