

Internal Rail-Guided Tension System

Designed to minimise the load imposed on structures

TESS120 is designed for lighter structures which require/desire tensioned fabric, The aluminium frame retains the tension force of the blind. The weight of the system is then distributed via multiple fixing points.

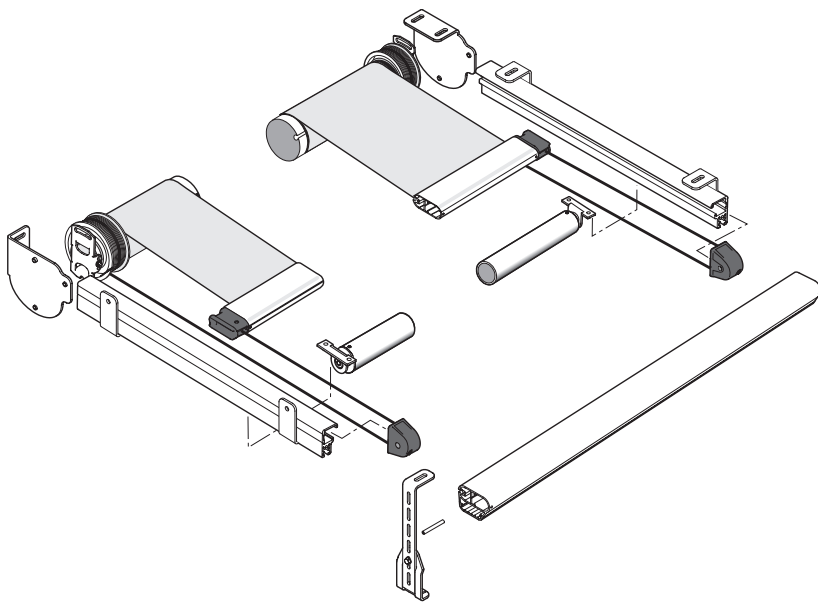

- Single barrel tension system
- Any angle, Any direction
- Minimal load on building
- Smooth, quiet travel
- Guide rails for maximum stability
- Reliable and robust
- Various colour finishes & fabric options

Key Facts

Typical Use

Light Structures, Retrofit

Shape

Rectangular

Running Direction

Any

Guides

Aluminium profile

Width

870 mm - 4000 mm

Draw

≤6500mm

Fabric Area

≤16 m²

Brackets

Aluminium

Relieving Rollers

Aluminium

Finish

RAL Powder coat

Installation options

Top/Back/Side



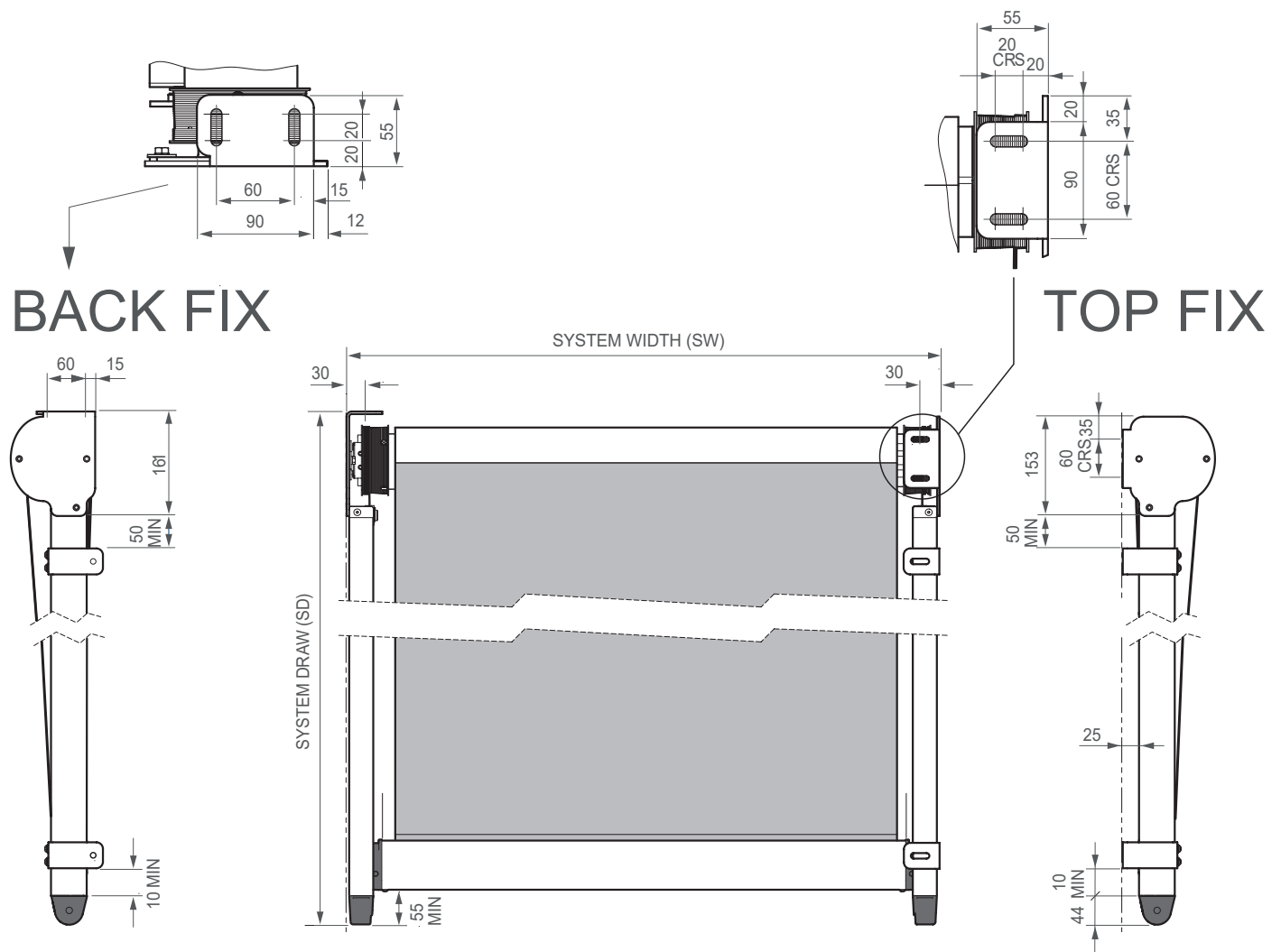

Technical Information

Fabric Tension

>100 N

Weight exc. fabric

~9 kg + 4.2 kg/m width + 3.1 kg/m draw

Fixing Load

5 Kg per fixing point

Max run time

4 min

Fabric speed

~5m/ min

Control

Radio/Wired

Motor

15 Nm, 17rpm

Operating Temp

0 to 55 °C

Electrical

230 V, 50 Hz, 140 W, 0.65A

120 V, 60 Hz, 130 W, 1.1A

